

Approx Gross Floor Area = 1135 Sq. Feet

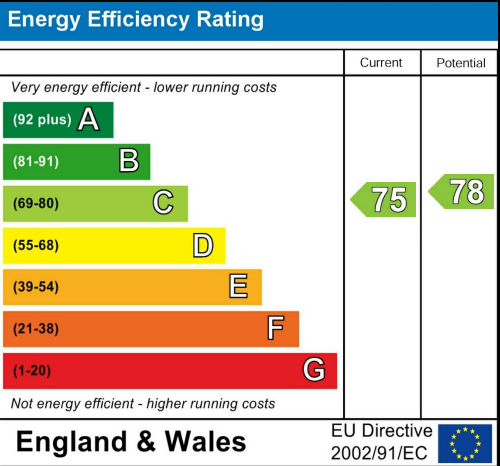

Stanhope Road | Bowdon
£2,500 Per Calendar
Month

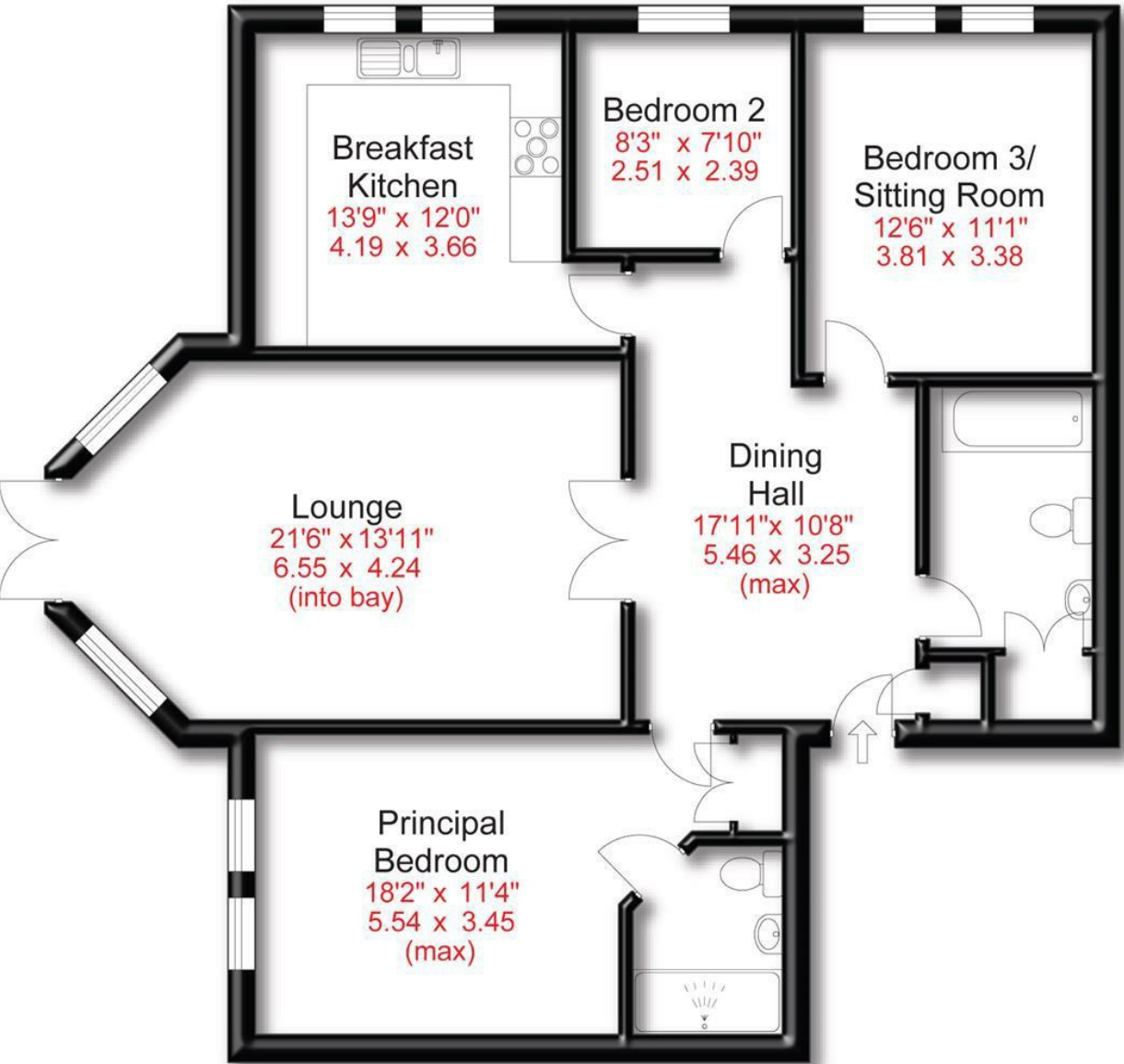

175 Ashley Road | Hale | WA15 9SD
t: 0161 928 9355
e: info@hibberthomes.com
www.hibberthomes.com

| Bedrooms 3 | Bath 2 | Reception 2 | Parking here | Area 1135.00 sq ft | Type here |
|------------|--------|-------------|--------------|--------------------|-----------|
| | | | | | |

- Ground Floor Apartment
- Walking Distance to Hale Village
- Beautiful Development
- 1135 sqft
- Three Bedrooms
- Lift & Secure Parking
- Immaculately Kept Grounds
- Service charge: £308.10 per month

A three bedroom ground floor apartment in exclusive Dunham House in Bowdon. Ground floor corner position with garden access. Stunning communal entrance, secure underground parking. Ideal location near transport links, amenities, and green spaces.

A superb ground floor corner position, providing sprawling accommodation with direct garden access. A welcoming dining hall connects the principal rooms which includes a stunning bay-fronted lounge with French doors into the gardens, a generous breakfast kitchen, generous main bedroom with ensuite shower room and two further bedrooms which are serviced by a three-piece bathroom. The living space is warmed via gas central heating and benefits double glazed windows throughout.

A secure underground car parking space is accessed via the lift and a further car parking space is found to the front.

Dunham Court is ideally positioned for easy access to various transport links including the motorway network and Manchester International Airport. The popular amenities of both Hale village and Altrincham town centre and just a few minutes drive away, as is the National Trusts' Dunham Massey and Dunham Golf Course.

Council tax Band F. EPC Rating: C. Available now.

